



Map No. 1 - Artikelly Settlement Context

-  Settlement Development Limit
-  Land Zoned for Economic Development

For Information Only

-  Existing Area of Economic Development
-  Major Area of Existing Open Space
-  Cycle Network (Existing)







Building Category

-  Commercial
-  Community Service
-  Economic
-  Health and Education

0 50 100 Metres

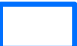





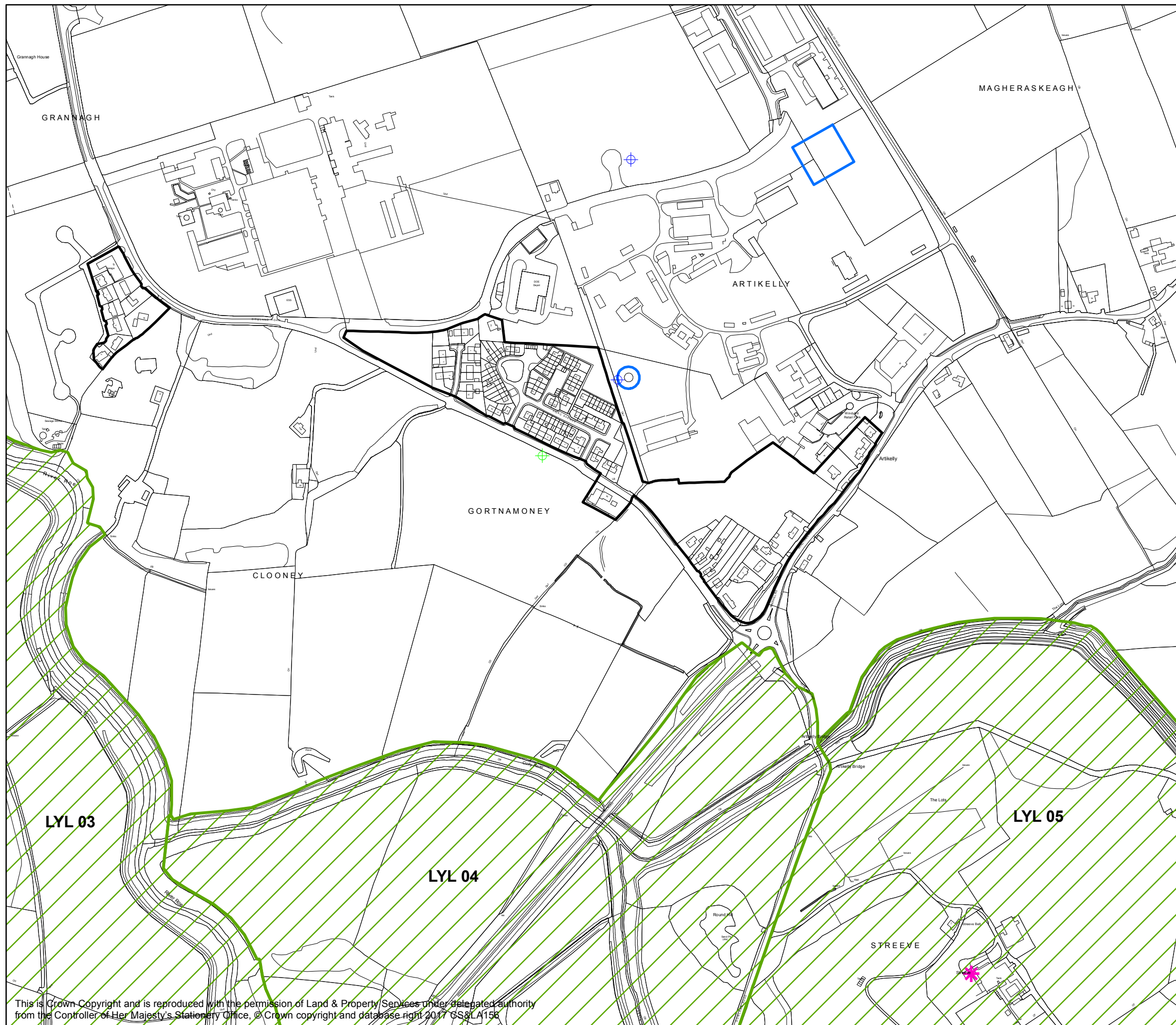
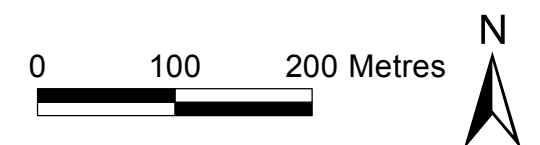

Map No. 2 - Artikelly No Local Landscape Policy Area Designated

-  Settlement Development Limit
-  Local Landscape Policy Area
-  Scheduled Historic Monument Areas
-  Listed Building
-  Archaeological Site & Monument (Scheduled)
-  Archaeological Site & Monument (Unscheduled)



Map No. 2 - Artikelly **No Local Landscape Policy Area** **Designated**

-  Settlement Development Limit
-  Local Landscape Policy Area
-  Scheduled Historic Monument Areas
-  Listed Building
-  Archaeological Site & Monument (Scheduled)
-  Archaeological Site & Monument (Unscheduled)



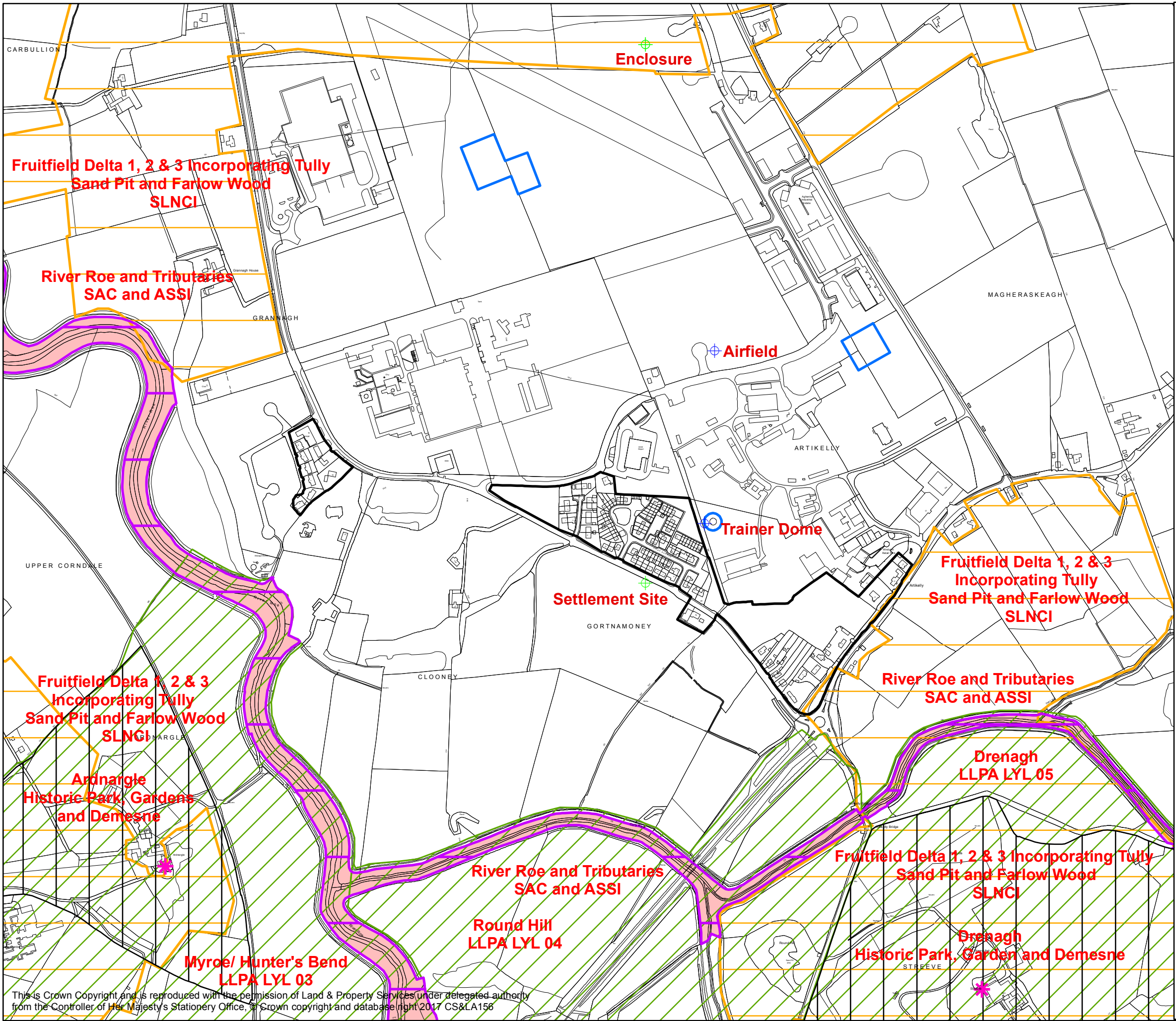

**Map No. 3
Artikelly
Built and Natural Environment**

- Settlement Development Limit
- Local Landscape Policy Area
- Historic Park, Garden & Demesne
- Special Area of Conservation
- Area of Special Scientific Interest
- Site of Local Nature Conservation Importance
- Scheduled Historic Monument Areas
- Listed Building
- Archaeological Site & Monument (Scheduled)
- Archaeological Site & Monument (Unscheduled)

This is Crown Copyright and is reproduced with the permission of Land & Property Services under delegated authority from the Controller of Her Majesty's Stationery Office, © Crown copyright and database right 2017 CS&LA156

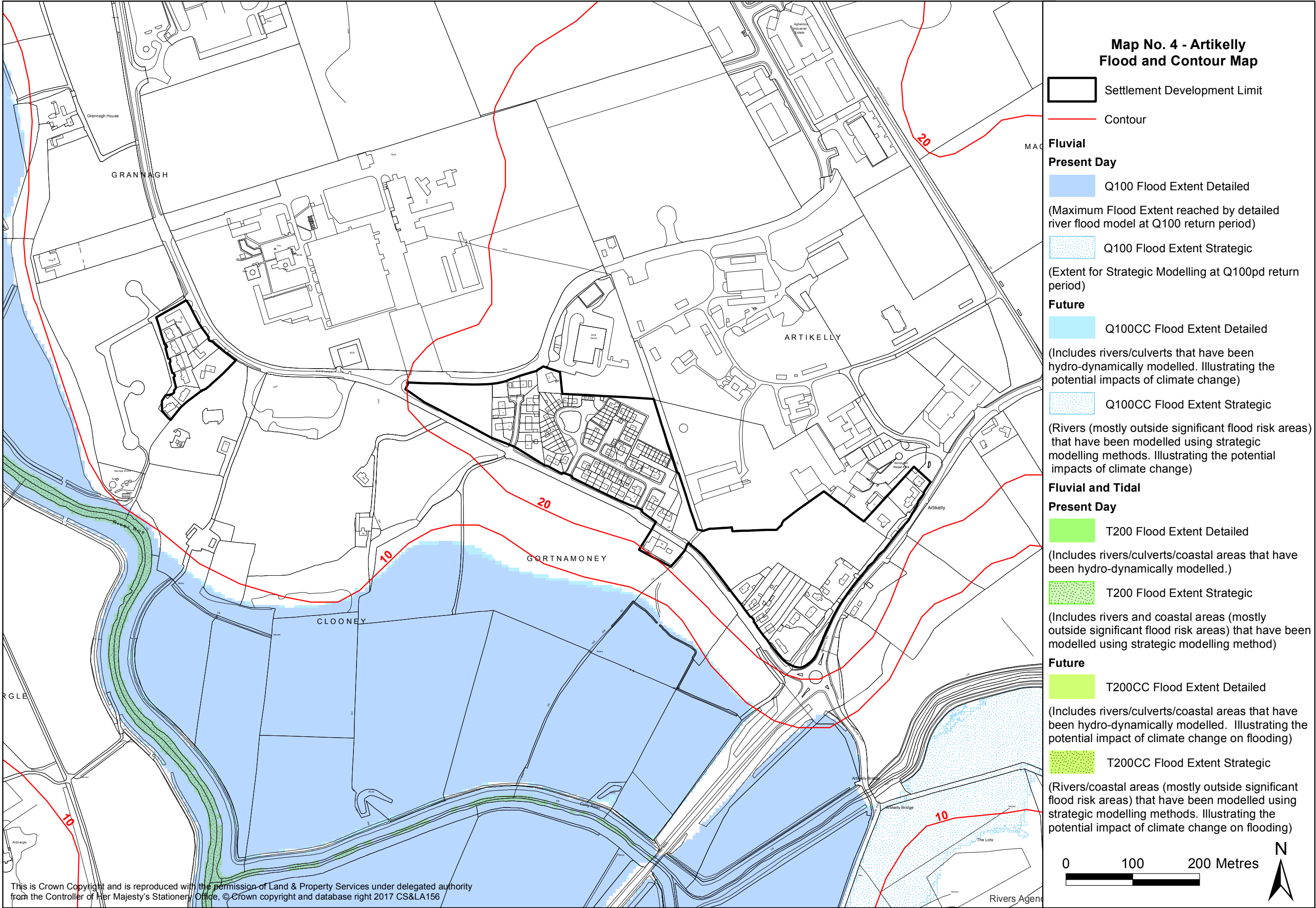

Map No. 5 - Artikelly
Fly Date: 05/05/2017



This is Crown Copyright and is reproduced with the permission of Land & Property Services under delegated authority from the Controller of Her Majesty's Stationery Office. © Crown copyright and database right 2017 CS&LA156

© Ordnance Survey of Northern Ireland