



Causeway
Coast & Glens
Borough Council

LA01/2024/0172/O

Proposed Infill Dwelling and Garage

Site: Approximately 75m South-West of 344 Craigs Road Rasharkin.

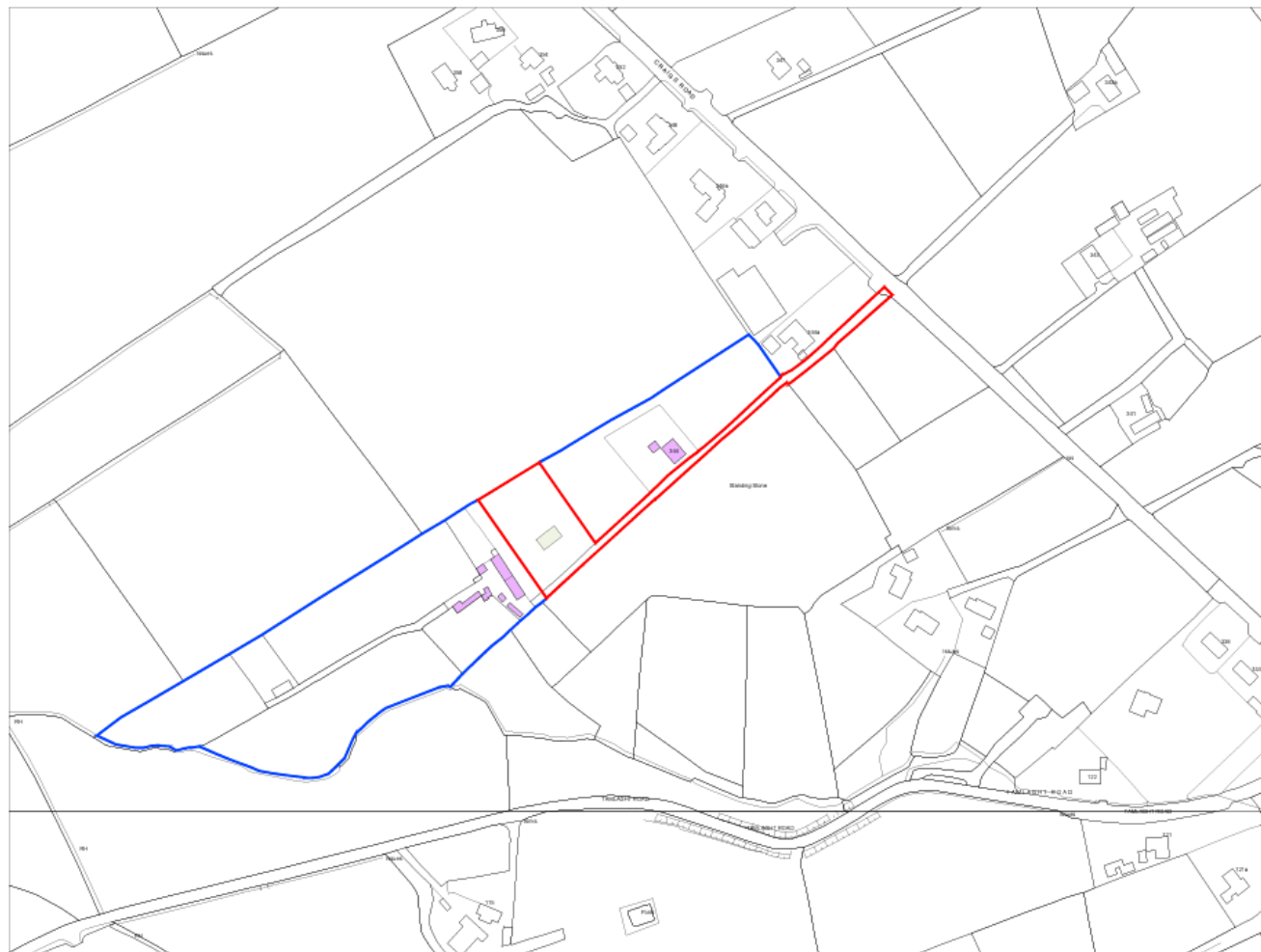

Site Location

Land Owned

Buildings Forming Ribbon Development

Indicative Locations of Infill Dwelling

Planning

Project: Proposed Infill Dwelling approximately 75m South West of 344 Craig Road, Rathfriland, B144 0EG

Client: Nigel Ritchie

Drawing Title: Site Location

Scale: 1:2500 WA3

AP1027-02a

18.01.2024

PD001

Checked by: JM

Checked by: MH

2020 Architects, 49 Main Street, Ballymoney, Co. Antrim, BT55 6AN
T: 028 276 67999



LA01/2024/0172/O

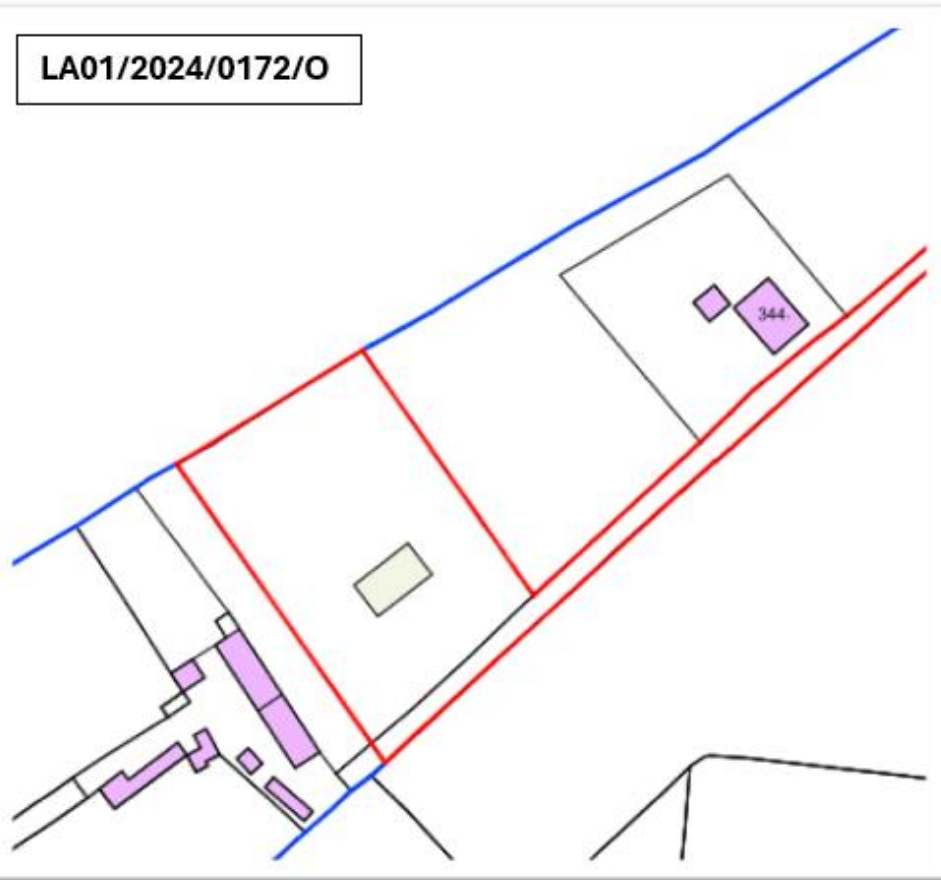

LA01/2024/0170/O

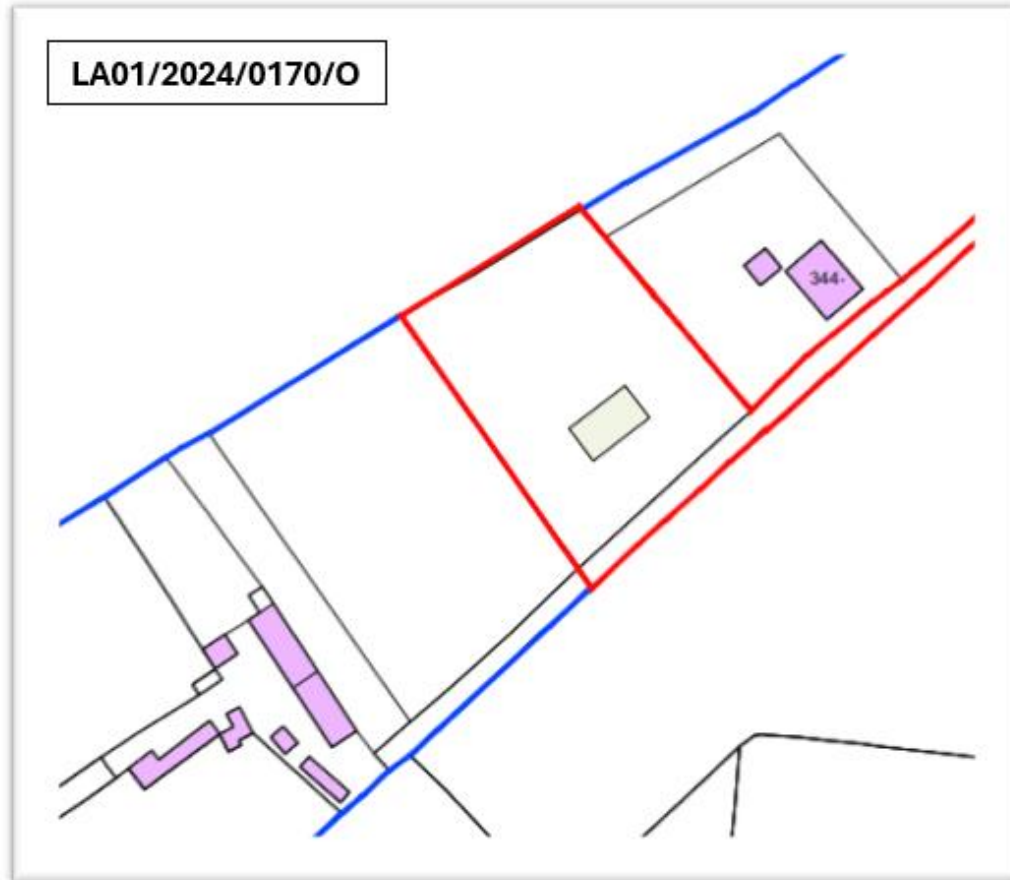

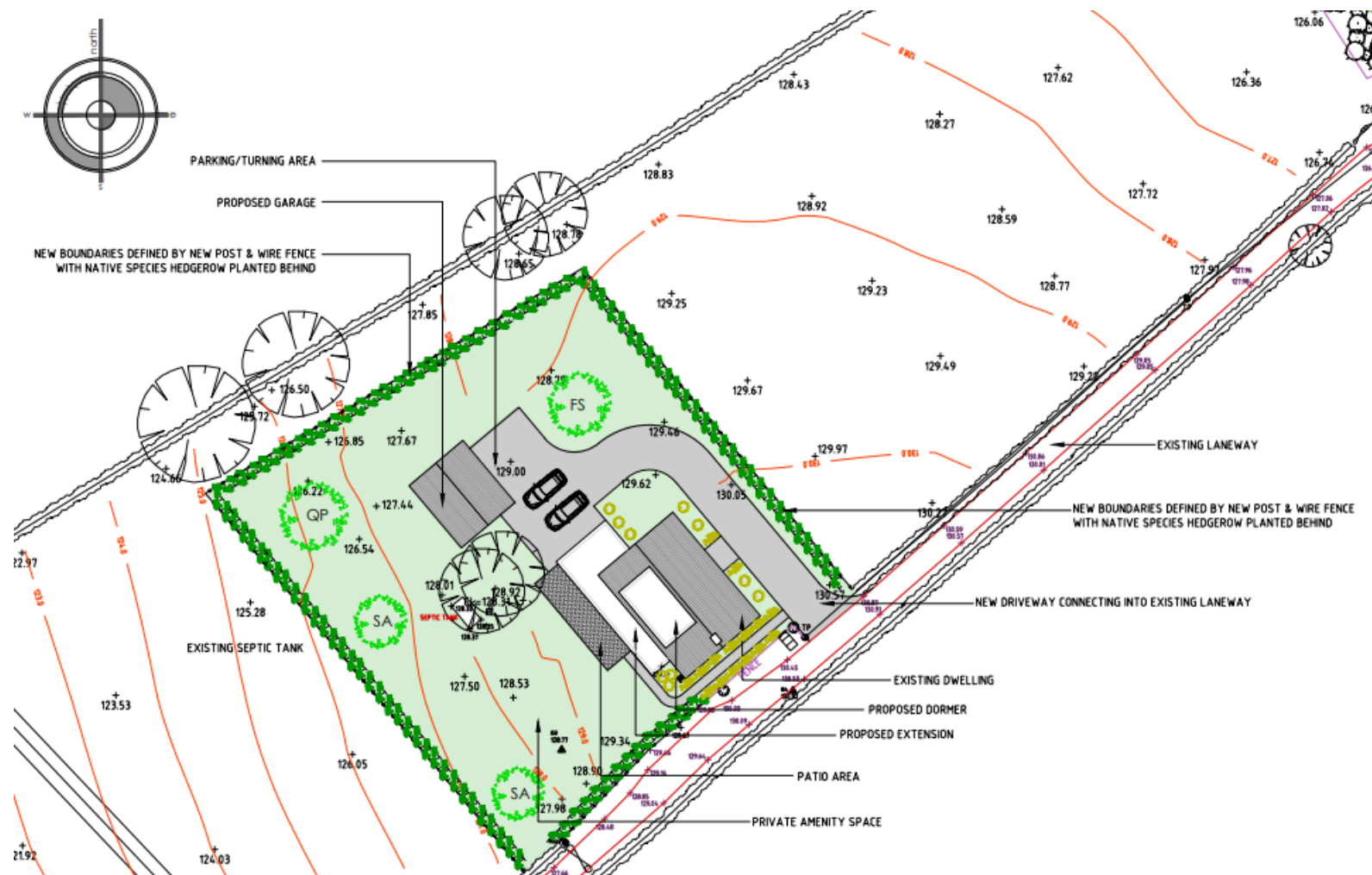







Causeway
Coast & Glens
Borough Council

LA01/2024/017/O & LA01/2024/0172/O

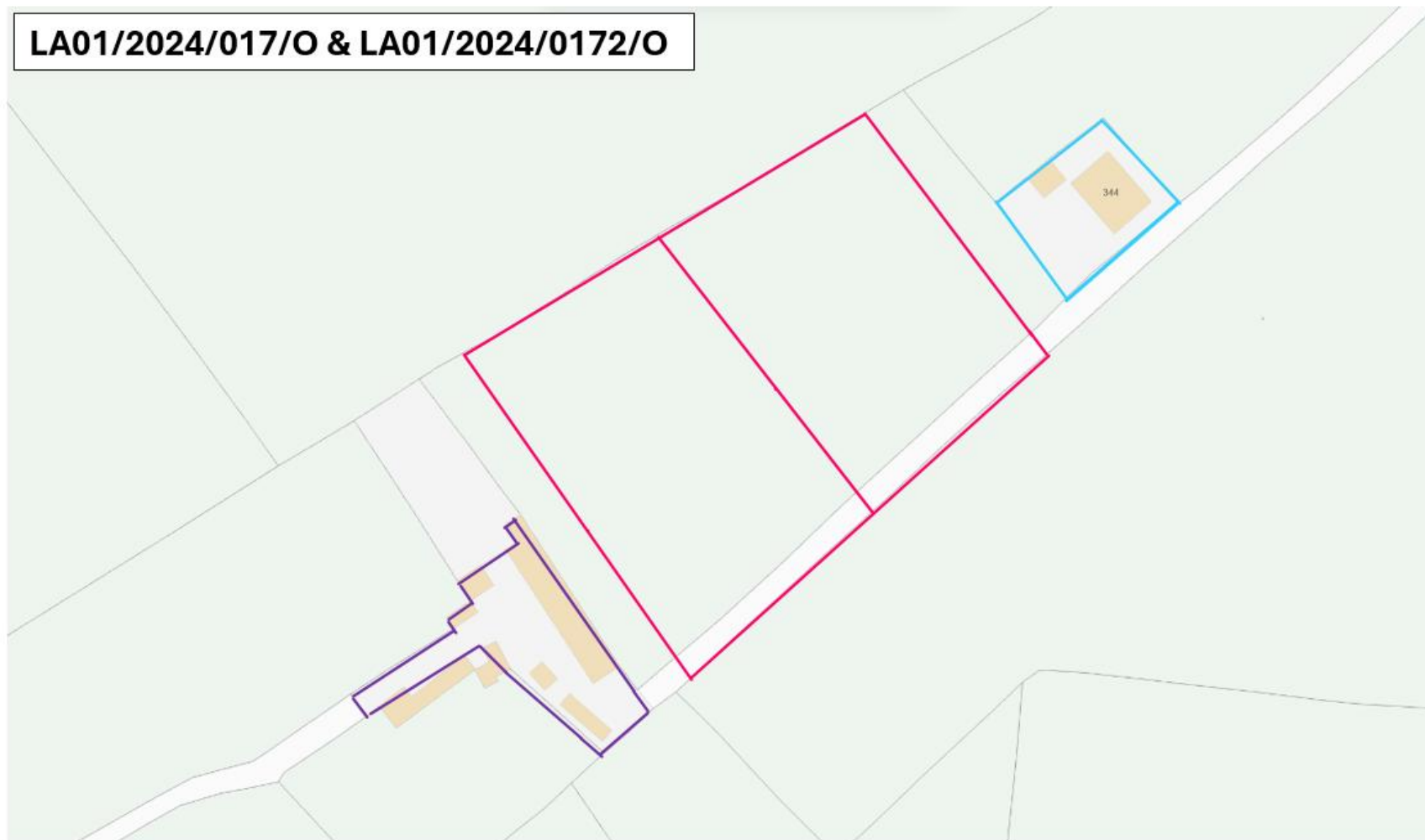

CTY 8 States: An exception will be permitted for the development of a small gap site sufficient only to accommodate up to a maximum of two houses within an otherwise substantial and continuously built-up frontage and provided this respects the existing development pattern along the frontage in terms of size, scale, siting and plot size and meets other planning and environmental requirements.

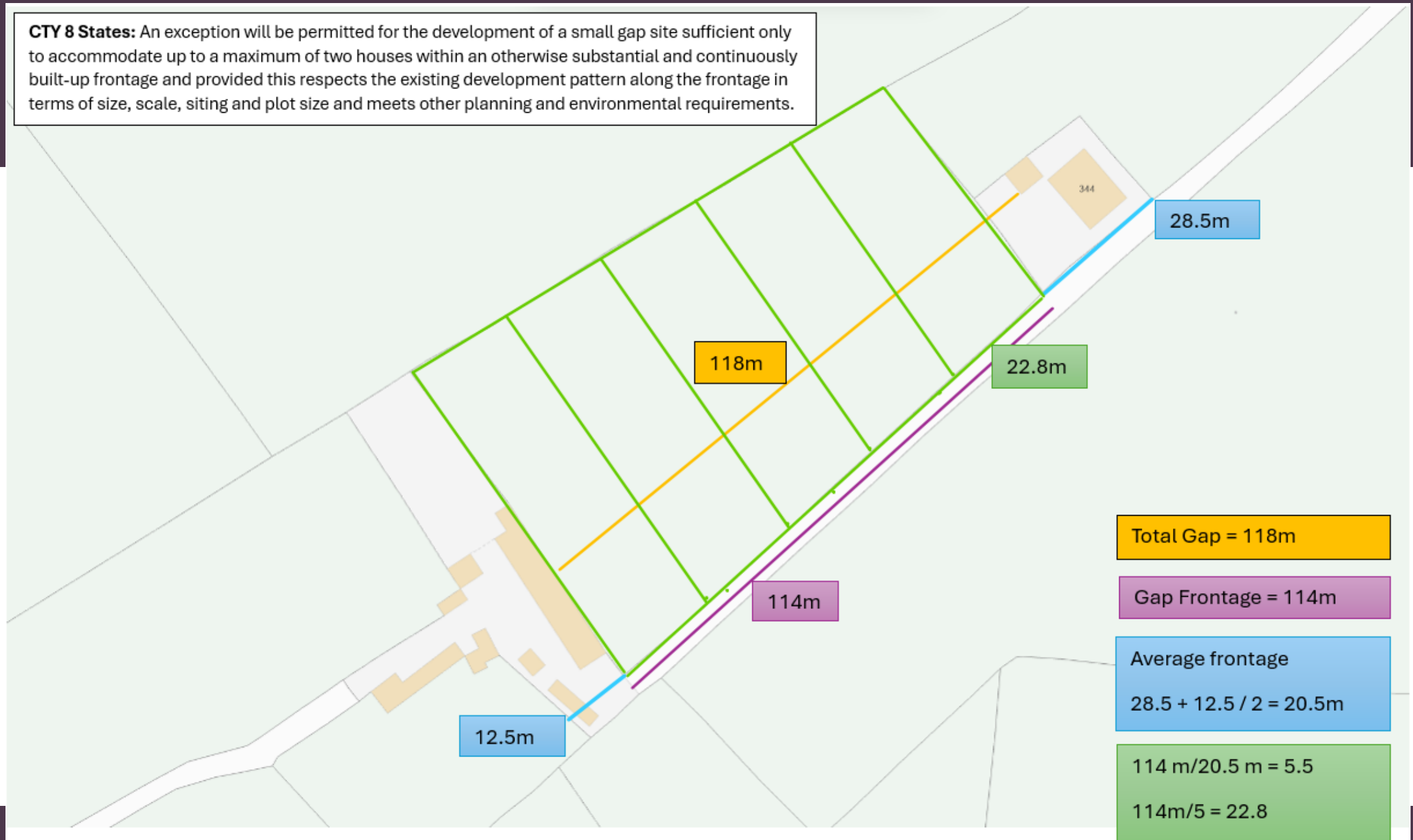

Frontage and Plot Size

- Where a gap frontage is longer than the average ribbon plot width the gap may be unsuitable for infill.
- When a gap is more than twice the length of the average plot width in the adjoining ribbon it is often unsuitable for infill with two new plots



LA01/2024/0170/O
Frontage = 46m
Area = 2832sq/m

LA01/2024/0172/O
Frontage = 46m
Area = 3237sq/m

No. 344
Frontage = 28.5m
Area = 690sq/m

120m SW of 344
Frontage = 12.5m
Area 912sq/m

Frontage = 22.8
Area= 1517sq/m



ACEmap® Single
Printed: 20/01/2021 Customer Ref:
Centre Point (Easting, Northing): 320918, 382378

LACB / 2021 / 0107

Scale: 1:1,250
Order no. ORD95177
Plan No. 11212SW

Planning Section
RECEIVED

01 FEB 2021

File No.

Drawing

Number...01...



COPYRIGHT STATEMENT
Except as otherwise permitted under the Copyright Designs and Patents Act 1988 this map may only be reproduced,
shown or transmitted in any form or by any means, with the permission of Land & Property Services.

PAC1

"This copy has been made by or with the authority
of Antrim and Newtownabbey Borough Council
pursuant to Section 47 of the Copyright Designs
and Patent Act 1988. Unless the Act provides a
relevant exception to copyright the copy must not
be copied without the prior permission of the
copyright owner"

