



Causeway
Coast & Glens
Borough Council

LA01/2024/0061/F

Three proposed glamping pods as part of a Farm Diversification Scheme

Agricultural Lands 12 metres North West of No. 18 Harbour Road, Ballintoy

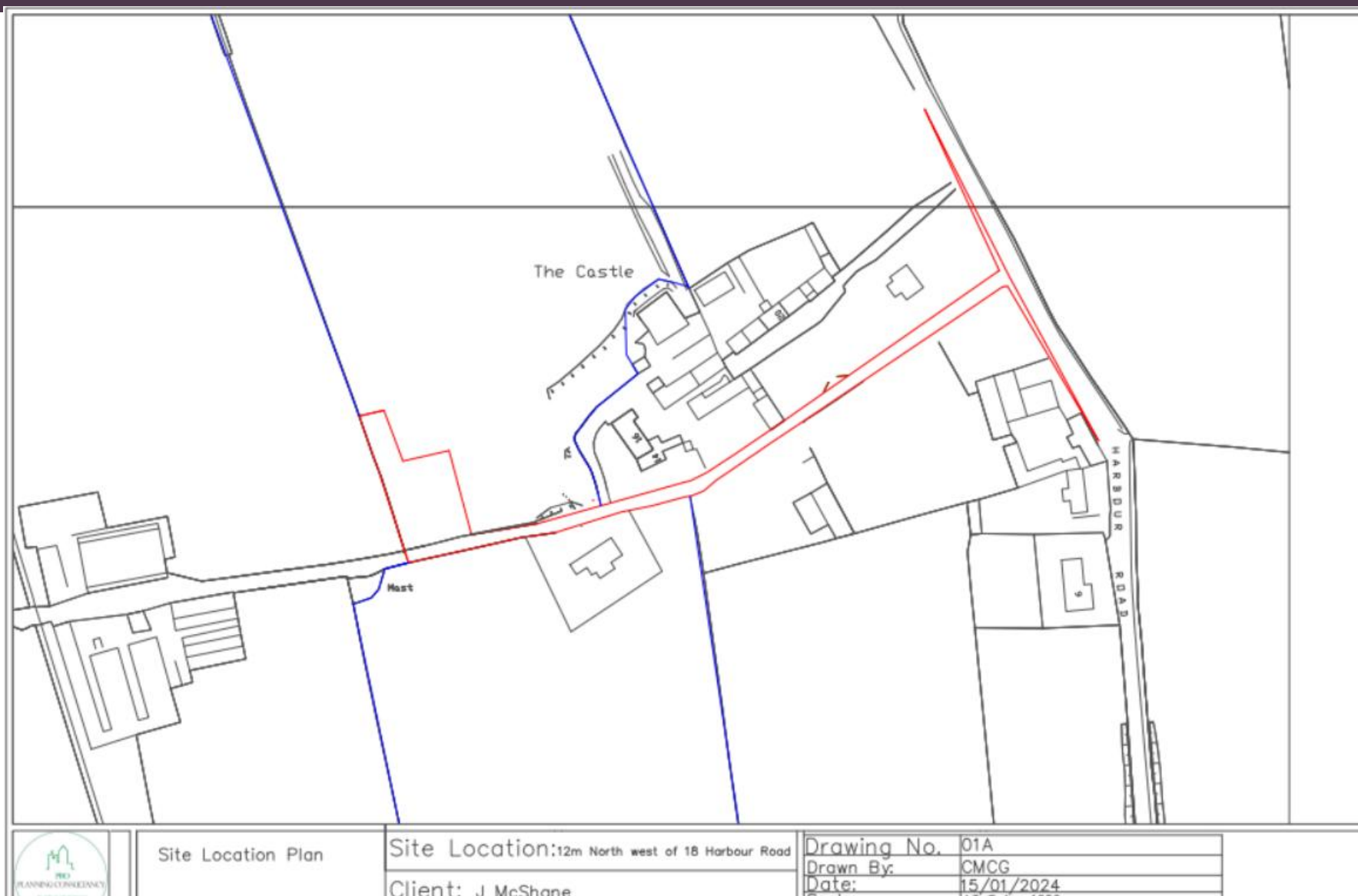





FRONT ELEVATION

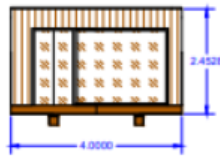

SIDE ELEVATION

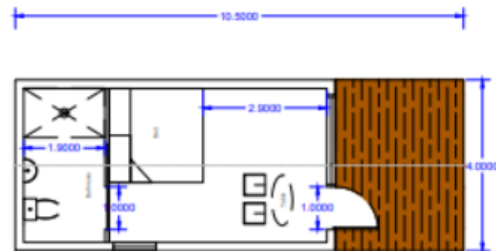
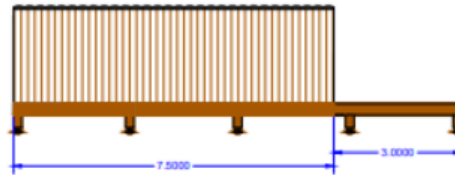

FLOOR PLAN

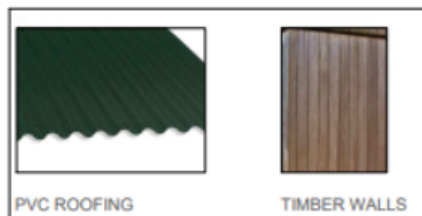
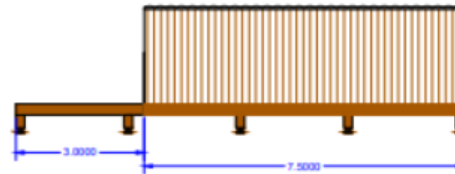

PVC ROOFING

TIMBER WALLS

Proposed Schedule of Finished Materials

- Roof - Insulated PVC Sheeting (Green)
- Walls Treated Timber
- Windows - Timber Framed Doubled Glazed
- Door - Timber Framed Doubled Glazed
- Rainwater - Aluminum Guttering



BLOCK PLAN - ILLUSTRATIONAL PURPOSES - NOT TO SCALE



Proposed Pods
Elevations

Site Location: 18 Harbour Road, Ballintoy

Client: J Mc Shane

Drawing No. 05B

Drawn By: CMCG

Date: 23-Sep-24

Scale: 1 : 100 A3

Revision: REV = B



Causeway
Coast & Glens
Borough Council











Causeway
Coast & Glens
Borough Council





Causeway
Coast & Glens
Borough Council

View from Listed Building No. 130 Whitepark Road







Causeway
Coast & Glens
Borough Council

