



Radiotherapy Project Altnagelvin Hospital

3 June 2016



Western Health
and Social Care Trust

Radiotherapy Service Vision

To provide innovative, holistic and compassionate Cancer Care for the North West of Ireland.

Radiotherapy Service Mission

To deliver safe, high quality care to our patients at the right time, in the right place within a culture of continuous improvement.



The New Centre



- A holistic, integrated service for cancer patients providing radiotherapy and chemotherapy for the common malignancies for patients of the Northwest of Ireland. Currently delivered by NICC, Dublin and Galway
- A highly complex, state of the art facility – “*A Hospital within a Hospital*”
- Delivering advanced treatments with state of the art LINACs and imaging technology
- Compassionate care
- Patient-centred



Improved Journey/Pathway

- Increased capacity meeting future demand
- Reduced travelling and waiting times
- Advanced state of the art treatment machines and imaging technology
- Modern up to date protocols
- Collaboration with Belfast/Dublin/Galway with peer review and mentoring
- Highly skilled workforce empowered and enthused
- IT-rich service / paper light
- Research integral to the new

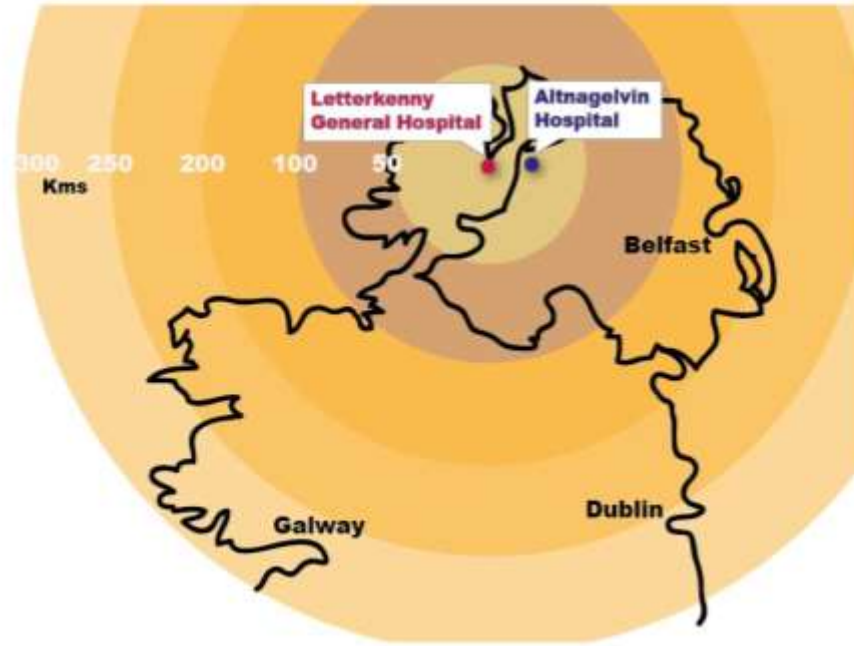

Catchment Population: approximately 500k

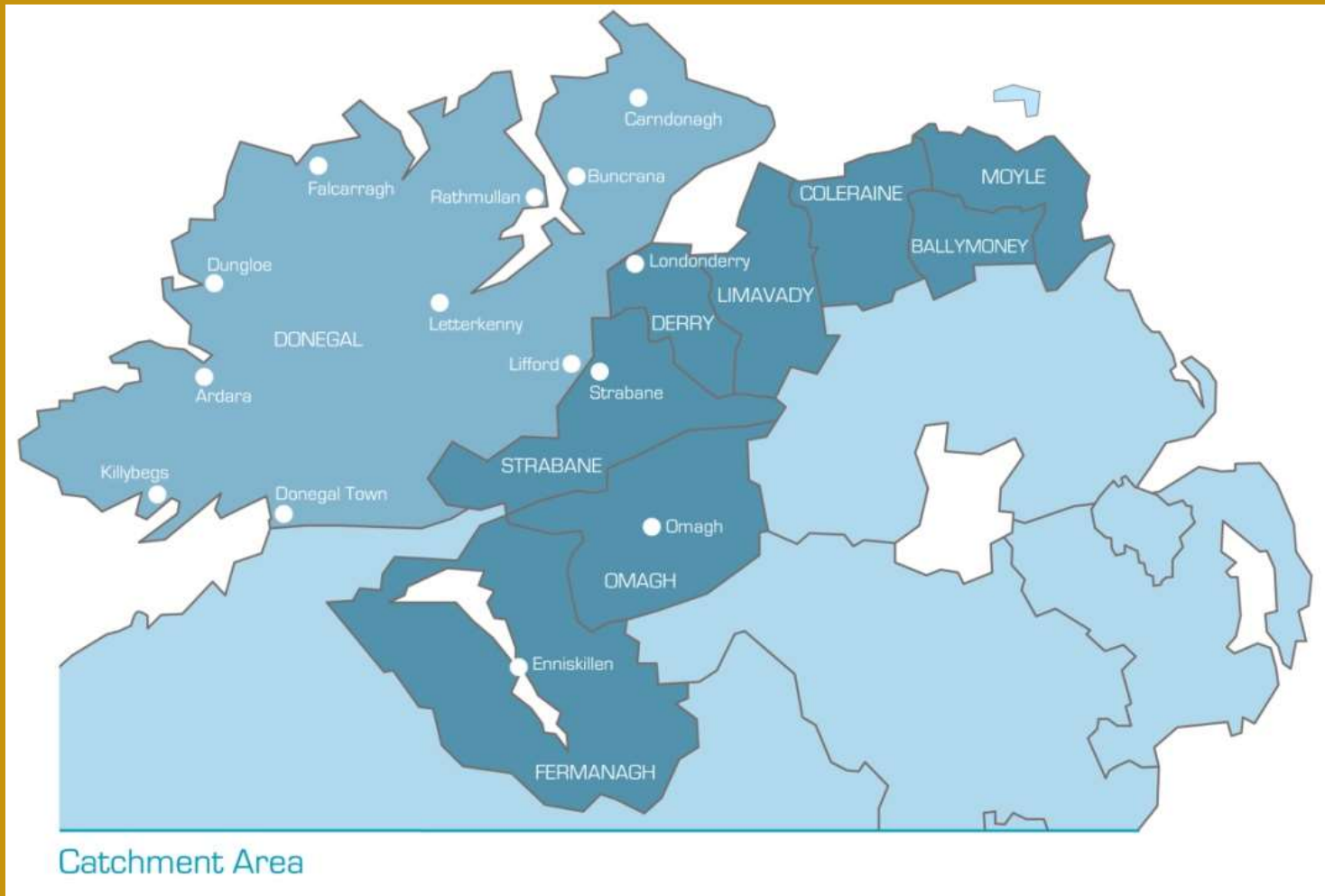

Radiotherapy Project

Key Work Strands:

- Funding Approvals
- Service Model and Patient Pathways
- Capital Planning
- Workforce Planning

Project Timeline (Subject to Funding Approval)

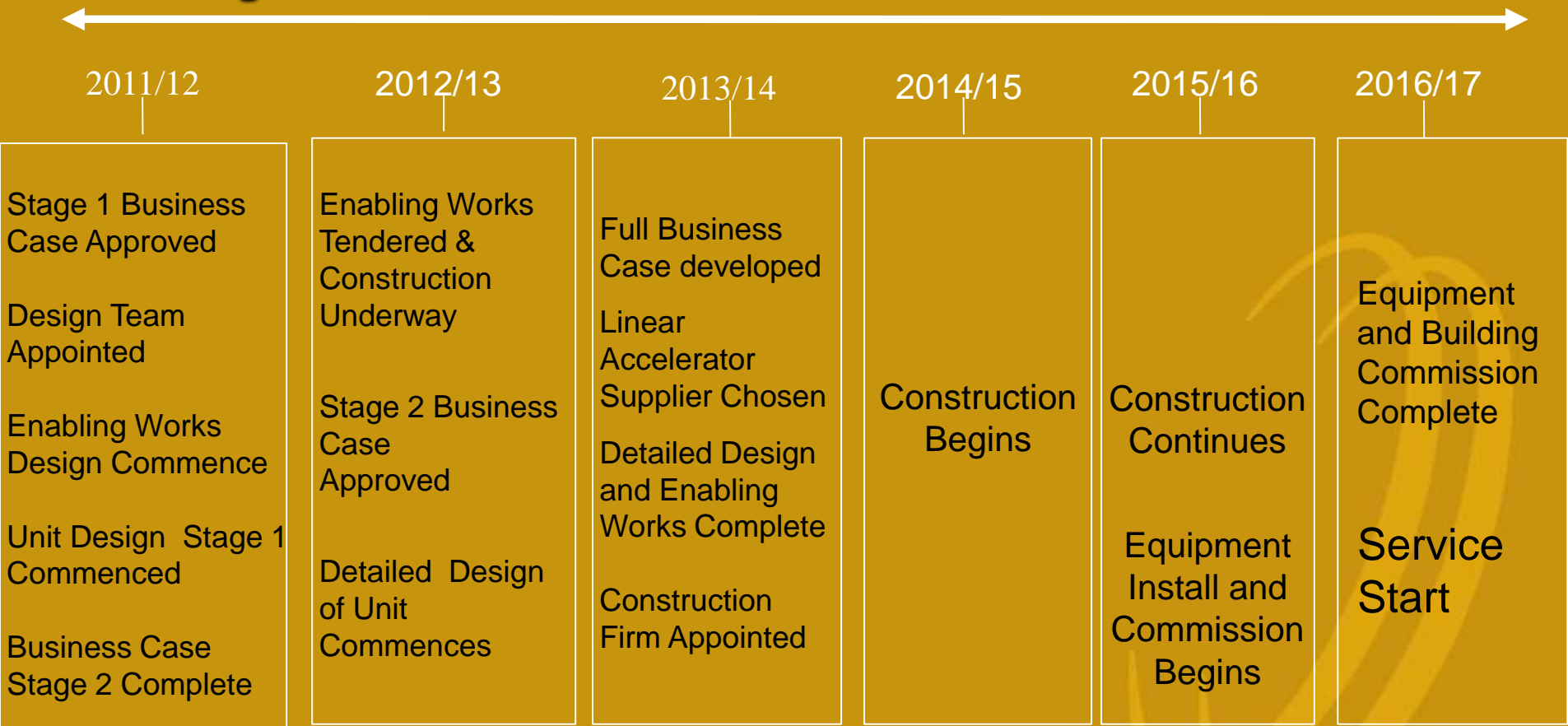

Service Model, Patient Pathways and Workforce Recruitment

VIEW FROM ROOF OF EXISTING TOWER



Western Health
and Social Care Trust















Western Health
and Social Care Trust

Equipment Decisions

Linear Accelerators	✓
CT Simulator	✓
Superficial Treatment Unit	✓
Diagnostic CT	✓
MRI	✓
Digital X-Ray	✓
Mould Room and Patient Treatment Devices	✓
General Equipment	



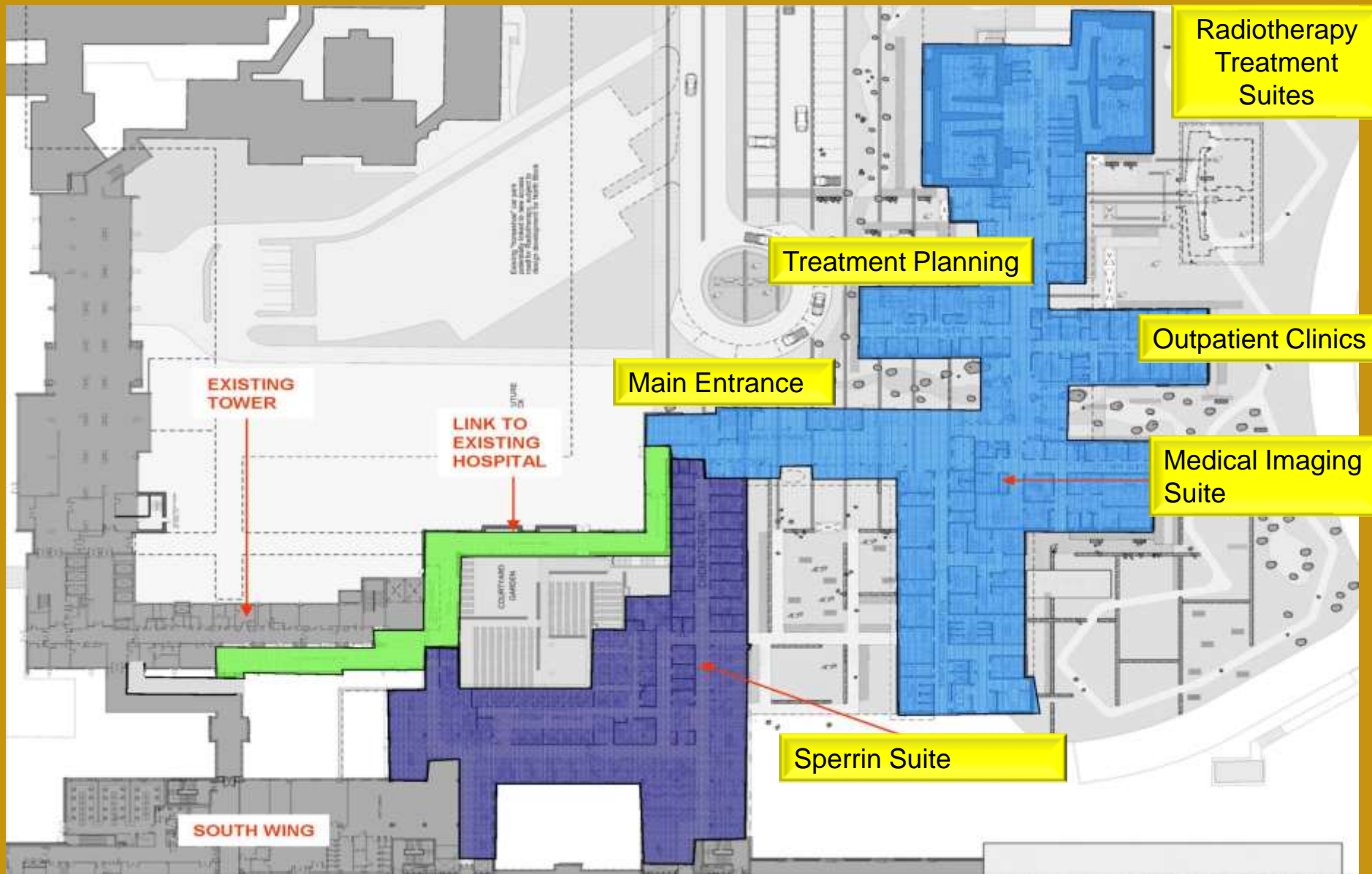

Approximately 215 Staff Required to Deliver Patient Centred Care

- Consultants and supporting medical team

- Nursing (ward, outpatient and chemotherapy)

- Medical physics scientists and technologists

- Therapeutic radiographers

- Diagnostic radiology and radiographers

- Pharmacy

- Pathology

- Administration

- Allied Health Professionals:

(Physiotherapy, Dietetics, SLT, OT)

- Counselling, Information Support

- Facilities Management



Staff Recruitment

WTE	June 2016 In Post	2016/17 offered posts	2016/17 to be recruited	Total Recurring
Medical	7.2	1.0	12.0	20.2*
Therapeutic Radiography (incls admin and Clinical Tutor)	29.0		10.0	39.0
Medical Physics (incls admin and regional physics service)	11.0	3.0	5.0	19.0
Medical Imaging (incls admin)	1.5	1.5	3.3	6.3
Inpatient Ward Nurses	4.0	4.0	13.89	21.89
Day Procs Unit Nurses	5.0	1.0	5.0	11.0
Outpatients Nurses	0.0	2.0	8.91	10.91
Pharmacy	0.0	2.0	6.0	8.0
Allied Health Profs	1.0	2.0	8.8	11.8
Pathology	0.0	0.0	1.5	1.5
Cardiology	0.0	0.0	0.5	0.5
Unit Manager and Secretary	2.0	0.0	0.0	2.0
Central Admin/ Sec Support	4.0	9.5	6.5	20.0
Patient Support	0.0	0.0	2.0	2.0
Prof Audit	0.0	0.0	1.0	1.0
Clinical Coding	0.0	2.5	0.0	2.5
Facilities Mgt	0.0	0.0	32.77	32.77
Corporate Support	0.0	0.0	4.0	4.0
Total	64.2	28.0	121.67	214.37



Western Health
and Social Care Trust



Western Health
and Social Care Trust

Radiotherapy Treatment Pathway

Multi Disciplinary Team Discussion



Relevant Investigations Performed
and Results Gathered in Local Area



Attend Altnagelvin Hospital for
Consultation and Treatment Planning



On Treatment Review



Follow Up Review

Partnership Working

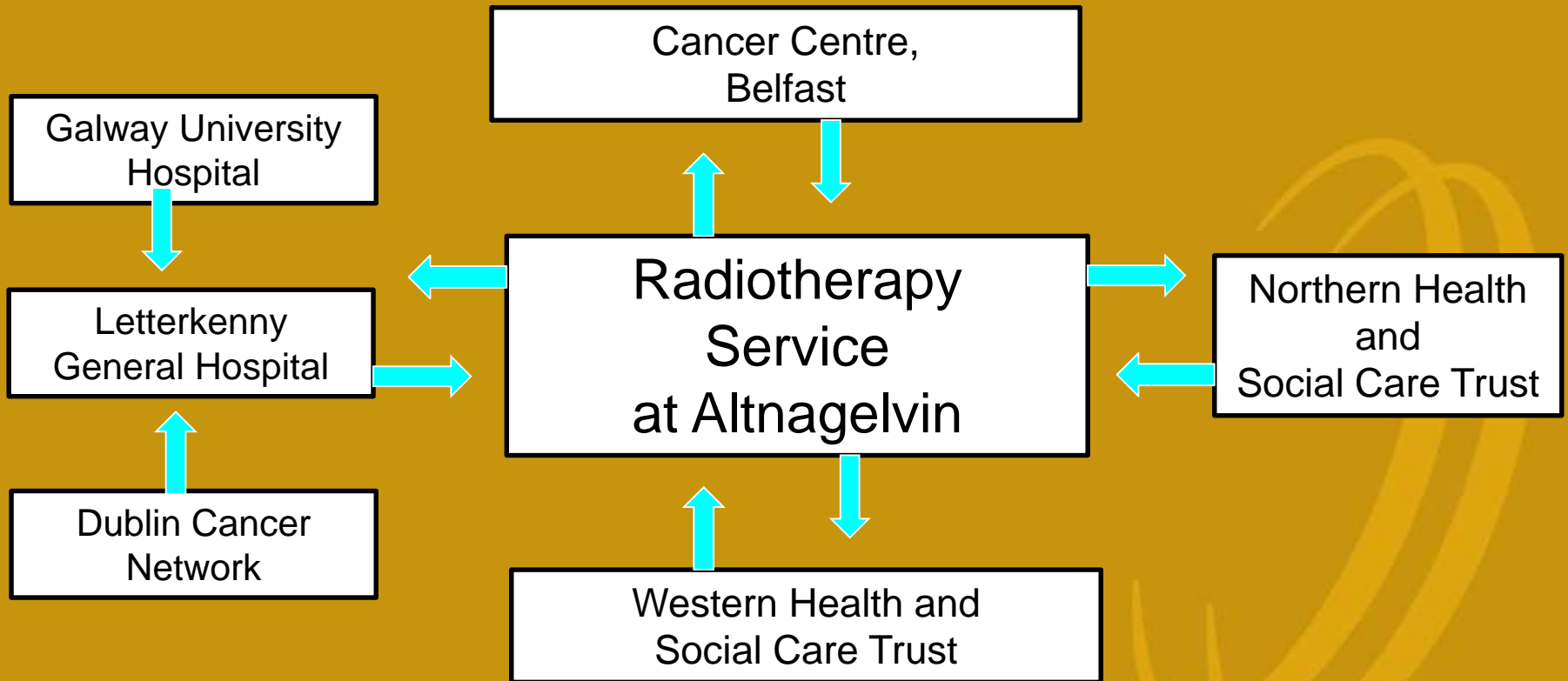

Cross-border Collaboration

- ❖ Design and deliver safe high quality patient services that will be seamless for our patients
- ❖ Working together to agree and enable the safe handover of patients who will require treatment.
- ❖ Electronic Exchange of Clinical Information
 - Clinical Pathway's
 - Referral's
 - Clinical Documents
 - Discharge Letters
 - OPD Letters



